

# DeKalb County Historic Preservation Commission

Tuesday, March 18, 2025- 6:00 P.M.

## Staff Report

### Consent Agenda

E. 1374 Harvard Road, Christine Thompson. Replace privacy fence. **1247457**

Built in 1951 - Nonhistoric (18 054 12 025)

This property is in the Druid Hills Character Area #2 and the Druid Hills National Register Historic District.

### Summary

The applicant proposes replacing the existing privacy fence on the property. The current 6ft wood privacy fence runs the perimeter of the backyard, extending to the garage on the left-side of the backyard and to the rear corners of the house. The current fence is failing and will be replaced in kind with pine wood. The sections of the fence facing towards Harvard Road and the driveway will be replaced with horizontal boards rather than vertical boards. There will be no change in the height or location of the fencing.

QUESTIONS FOR APPLICANT:

### Recommendation

**Defer.** The required signage was not posted in the required time period in order to meet public notification requirements. With the agreement of the applicant, the application should be deferred to the next meeting in order for the proper public notification requirements to be met.

### Relevant Guidelines

5.0 *Design Review Objective* (p45) - When making a material change to a structure that is in view from a public right-of-

way, a higher standard is required to ensure that design changes are compatible with the architectural style of the structure and retain character-defining features. When a proposed material change to a structure is not in view from the public-right-way, the Preservation Commission may review the project with a less strict standard so as to allow the owner more flexibility. Such changes, however, shall not have a substantial adverse effect on the overall architectural character of the structure.

9.4 *Enclosures and Walls* (p90) Recommendation - Fences are appropriate in rear yard spaces. Rear yard fences should be coordinated with existing county codes. Suggested materials include wood and chain link. Vinyl- covered chain link fencing, typically in bronze, brown, or black, assist in making fences less obtrusive. Vines are suggested to "soften" the appearance of metal chain link fencing. If wood fencing is used, the paint color and design should be compatible with the architecture of the adjacent residence. Fence heights can range from 4' to 6' depending on the reason for the enclosure.



DeKalb County  
GEORGIA

Development Services Center  
178 Sams Street  
Decatur, GA 30030  
[www.dekalbcountyga.gov/planning](http://www.dekalbcountyga.gov/planning)  
404-371-2155 (o); 404-371-4556 (f)

Chief Executive Officer  
Michael Thurmond

**DEPARTMENT OF PLANNING & SUSTAINABILITY**

Interim Director  
Cedric Hudson

**Application for Certificate of Appropriateness**

Date submitted: 2/10/2025 Date Received: \_\_\_\_\_

Address of Subject Property: 1374 Harvard Rd NE, Atlanta, Georgia 30306

Applicant: Christine Thompson E-Mail: cethompson1118@yahoo.com

Applicant Mailing Address: 1374 Harvard Rd, NE, Atlanta, Georgia 30306

Applicant Phone: 770-877-0500

Applicant's relationship to the owner: Owner  Architect  Contractor/Builder  Other

\*\*\*\*\*

Owner(s): Christine Thompson Email: cethompson1118@yahoo.com

Owner(s): John Grijak Email: jpgrijak@gmail.com

Owner(s) Mailing Address: 1374 Harvard Rd NE, Atlanta, Georgia 30306

Owner(s) Telephone Number: 770-877-0500

Approximate date of construction of the primary structure on the property and any other structures affected by this project: 1951

Nature of work (check all that apply):

- |                   |                          |                        |                                     |                             |                          |
|-------------------|--------------------------|------------------------|-------------------------------------|-----------------------------|--------------------------|
| New construction  | <input type="checkbox"/> | New Accessory Building | <input type="checkbox"/>            | Other Building Changes      | <input type="checkbox"/> |
| Demolition        | <input type="checkbox"/> | Landscaping            | <input type="checkbox"/>            | Other Environmental Changes | <input type="checkbox"/> |
| Addition          | <input type="checkbox"/> | Fence/Wall             | <input checked="" type="checkbox"/> | Other                       | <input type="checkbox"/> |
| Moving a Building | <input type="checkbox"/> | Sign Installation      | <input type="checkbox"/>            |                             |                          |

Description of Work:

Replace existing 6 ft privacy fence that is falling down. Fence will be the same with the exception of the street and drive way facing sections will be upgraded to horizontal privacy to better fit with the style of the house. The fence material will be upgraded to cedar from pine. See enclosed estimate and drawings

This form must be completed in its entirety and be accompanied by supporting documents, such as plans, list of materials, color samples, photographs, etc. All documents should be in PDF format, except for photographs, which may be in JPEG format. Email the application and supporting material to [plansustain@dekalbcountyga.gov](mailto:plansustain@dekalbcountyga.gov) and [pvjennings@dekalbcountyga.gov](mailto:pvjennings@dekalbcountyga.gov). An incomplete application will not be accepted.

Signature of Applicant: 



# Chamblee Fence Company, Inc.

4760 Peachtree Industrial Blvd., Berkeley Lake, GA 30071-1547  
(770) 396-4200 \ Fax (770) 393-3415

We Accept



Customer: <u>Christine Thompson</u>	Home #	Date: <u>2-1-25</u>
Address: <u>1374 Harvard Rd. NE</u>	Work #	Subdivision:
City: <u>Atlanta</u> State: <u>GA</u> Zip: <u>30306</u>	Cell # <u>770-877-0500</u>	
Job Address:	Email: <u>cethompson1118@yahoo.com</u>	

FOOTAGE	FENCE TYPE	HEIGHT
215	Pressure Treated Pine	6
	Privacy DE	
42	Cedar Horizontal - No Spac	6'-8"
32	Cedar Horizontal w/ 1/2" Spac	5
292	Removal + Disposal wood	6

Qty.	Size	GATES	Type & Style
1	5x5		walk - Horizontal
1	4x7		walk - Horizontal

### WOOD SPECIFICATIONS

1"x 4" Pickets	<input type="checkbox"/>	
1"x 6" Boards	<input checked="" type="checkbox"/>	
Cedar	<input checked="" type="checkbox"/>	
P.T. Pine	<input checked="" type="checkbox"/>	

4"x 4" Posts	<input checked="" type="checkbox"/>	
4"x 6" Posts	<input type="checkbox"/>	
6"x 6" Posts	<input type="checkbox"/>	

2"x 4" Runners	Cedar	<input type="checkbox"/>
(2) (3) (4)	P.T. Pine	<input checked="" type="checkbox"/>

### Panel Design

<input checked="" type="checkbox"/> Straight	<input type="checkbox"/> Neg. Scallop	<input type="checkbox"/> Pos. Scallop	<input checked="" type="checkbox"/> Horizontal
<input type="checkbox"/> Other			

### Construction Design

### Top of Fence

Face	<input checked="" type="checkbox"/>	Slope with grade (less space)	<input checked="" type="checkbox"/>
Exposed	<input type="checkbox"/>	Straight (more space at bottom)	<input checked="" type="checkbox"/>
Between	<input type="checkbox"/>	Step (large spaces at bottom)	<input type="checkbox"/>

### CHAIN LINK SPECIFICATIONS

Fabric/Gauge	Gate Posts
Top Rail	Gate Frame
Line Posts	Barbed Wire
Terminal Posts	Tension Wire

### ORNAMENTAL SPECIFICATIONS

<input type="checkbox"/> Aluminum	<input type="checkbox"/> Steel
<input type="checkbox"/> Height	<input type="checkbox"/> Style
<input type="checkbox"/> Color	<input type="checkbox"/> Picket size
<input type="checkbox"/> Rings	<input type="checkbox"/> Post size
<input type="checkbox"/> Finials ( )Plastic ( )Metal ( )Triad ( )Quad Flare	<input type="checkbox"/> Post Caps

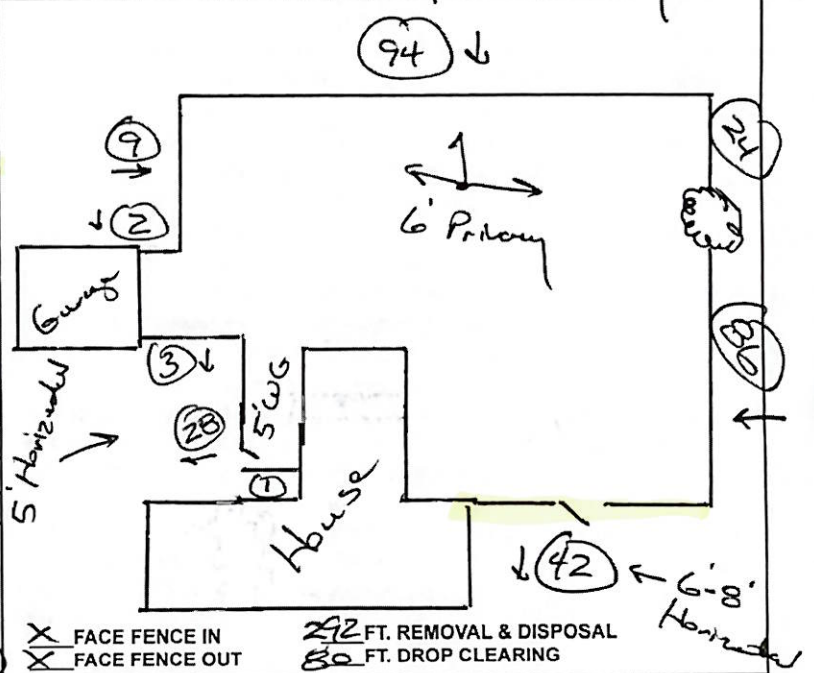

FACE FENCE IN      292 FT. REMOVAL & DISPOSAL  
 FACE FENCE OUT      80 FT. DROP CLEARING

- Purchaser agrees that final price will be determined by final installed footage.
  - Purchaser is responsible for locating property lines, and is solely responsible for fence location.
  - Purchaser accepts terms & conditions page.
  - Chamblee Fence is not responsible for damage to underground systems, except marked utilities.
- Wood fence components, when exposed to the elements are subject to immediate warpage, shrinkage, cracking, etc.  
 Price valid for 14 days • Credit card purchases subject to a 3.5% surcharge

### COMMENTS / SPECIAL INSTRUCTIONS

Approximate Installation 2/4 weeks from deposit/signed contract

Total Price \$ <u>9898.00</u>	Revised Price \$
Deposit <u>1/2</u> \$ <u>4949.00</u>	Deposit \$
Balance \$	Balance \$

TERMS: 1/2 Deposit • Balance Due upon Completion

SUBJECT TO CONDITIONS ON REVERSE

Accepted by Purchaser	Date
Estimator <u>Robert W. W...</u>	Date <u>2-1-25</u>
Accepted by Chamblee Fence Company, Inc.	Date

Tree Well + 396 cedar + 604 + 6' + 44